

An Overview of the ePlan Journey with a Focus on the Victorian ePlan 2025 Roadmap

Dr Hamed Olfat

ePlan Coordinator | Land Use Victoria

Chairman of Technical Committee | ICSM ePlan Working Group

Visualisation

Spatial
analysis

Validation

DCDB
Upgrade

ePLAN

Digital
Examination

LandXML

Outline

- ePlan Overview
- ICSM ePlan Working Group Updates
- The Victorian ePlan Services Demo
- The Victorian ePlan 2025 Roadmap

Paper/PDF/TIFF Plan vs ePlan

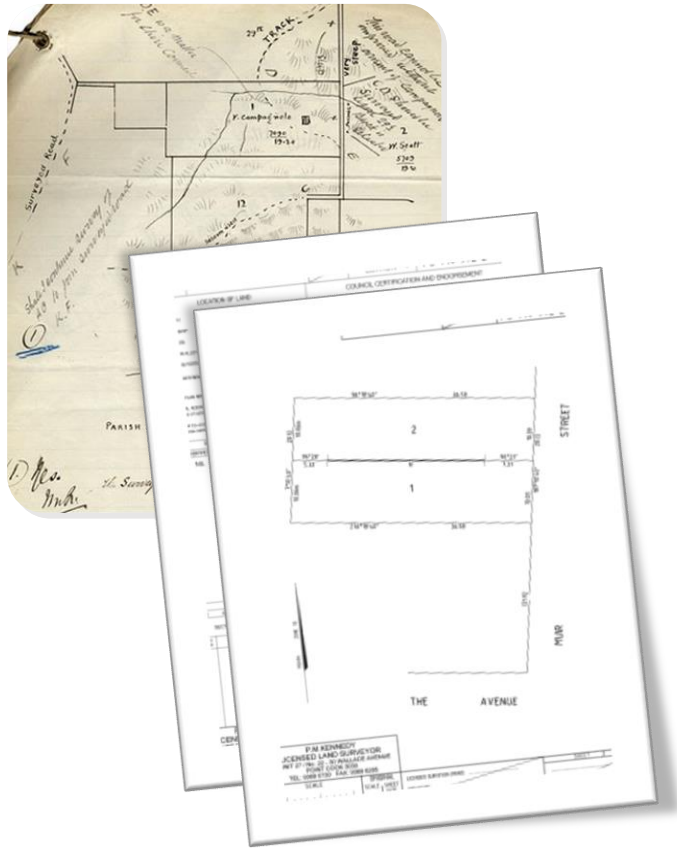

VS

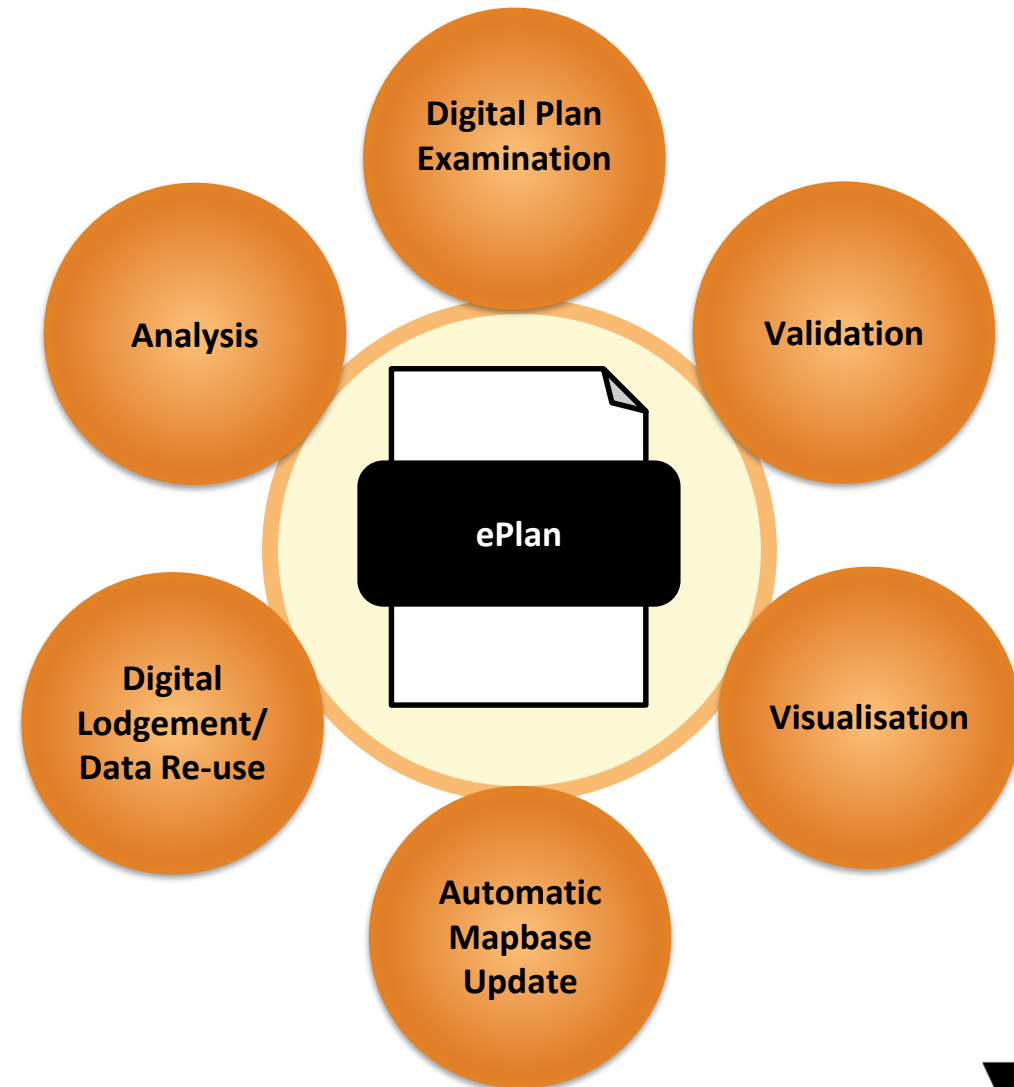

ICSM ePlan Working Group Updates



- 2003 - ePlan Working Group was established under ICSM Permanent Committee on Cadastre (PCC)
- 2009 - Developed a **national ePlan data model** to support the transfer of digital cadastral and survey data between surveying industry and land authorities
- 2011 - Developed an **ePlan Protocol based on LandXML**
- NZ, QLD, VIC, NSW and Singapore have adopted the ePlan LandXML Protocol
- 2011-2014 – Collaboration between QLD/VIC/NSW on **validation and visualisation services**
- 2014 – commenced investigation on **3D digital cadastre** following the ICSM Cadastre 2034 Strategy
- 2018 – **TOR** is under review

ICSM ePlan Working Group Updates - NZ



- Mandated ePlan LandXML lodgement in **Landonline** in 2007
- Currently, designing a new system namely **Advanced Survey and Titles System (ASaTS)** to support both 2D and 3D ePlan

ICSM ePlan Working Group Updates - QLD

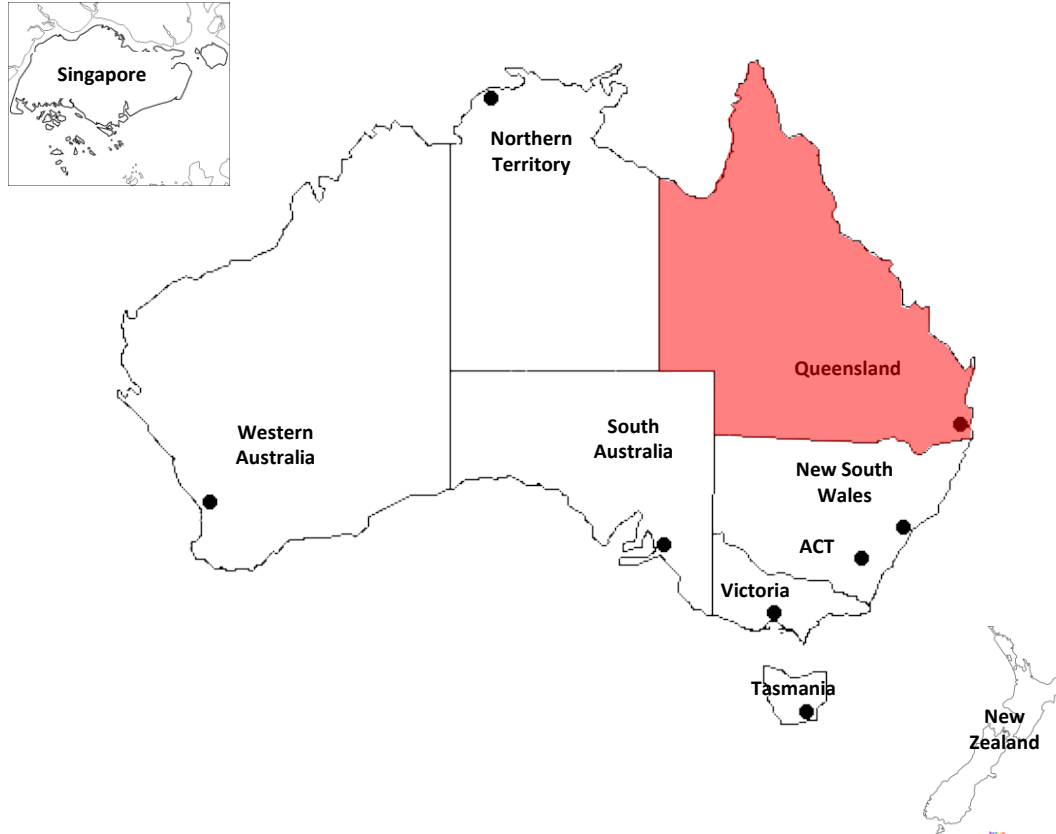

- **Cadastre QLD Transformation** project is looking to transform its land related information systems and processes, including the digital exchange of survey information
- Part of this work is defining a new business model to support the creation of a **survey accurate digital cadastre**, which is currently underway
- QLD are leveraging from similar work being undertaken in NSW and VIC as part of a collaborative approach
- The new model will be based on producing LandXMLs in alignment with the national ePlan schema
- This work is being undertaken in collaboration with key stakeholders, including surveyors and local government authorities.

ICSM ePlan Working Group Updates - NSW

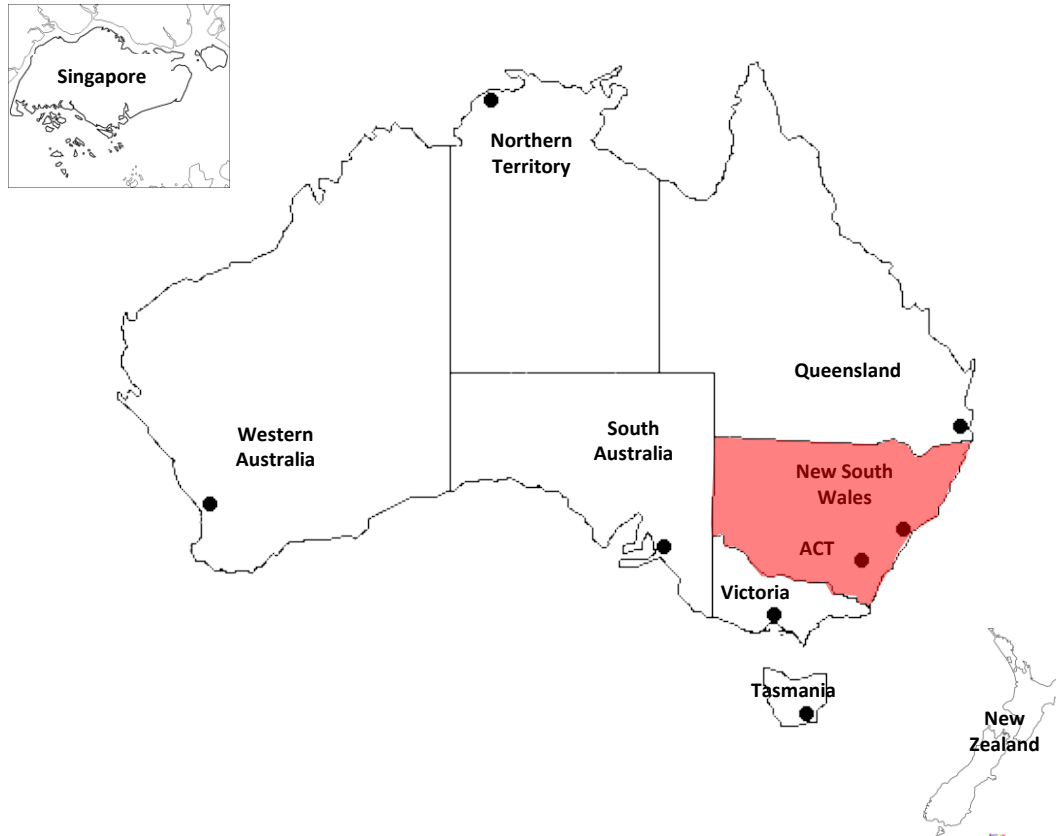

- NSW Land Registry Services (formerly Land and Property Information) has entered into a **concession agreement** between NSW government and Australian Registry Investment for period of 35 years
- Total digital (LandXML) lodgements from September, 2012 to date is **1192**
- **133 surveyors and 66 surveying firms** on board
- NSW LRS successfully accepted **first digital Strata Plan lodgement** in September, 2017
- NSW LRS has received digital lodgements created by surveyors using **12 different software packages**
- **Back-capture project** has now captured over 220,000 plans in landXML
- **Priority channel** established with supplier for newly registered plans

ICSM ePlan Working Group Updates - VIC

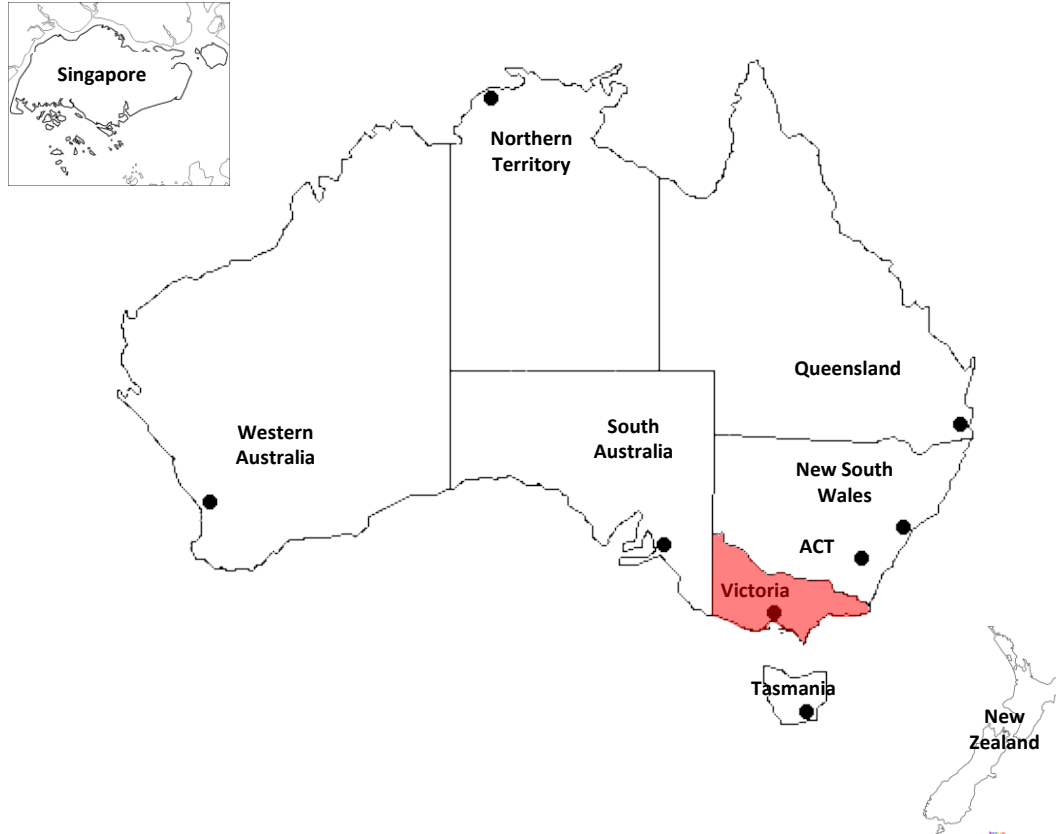

- **SPEAR**, the cadastral plan lodgement portal, has been ePlan-enabled for 2D plans since 2013
- Available services include validation, visualisation, data viewer, data storage, data download and visualisation enhancement tool
- Three software packages support ePlan
- On average, one ePlan is submitted to SPEAR every week
- An **ePlan Pilot** with 21 surveying firms is underway
- Investigating the technical aspect of a **3D digital cadastre** since 2014
- **Modernising the Digital Cadastre** through back capturing cadastral plans in LandXML format is underway

ICSM ePlan Working Group Updates - Singapore

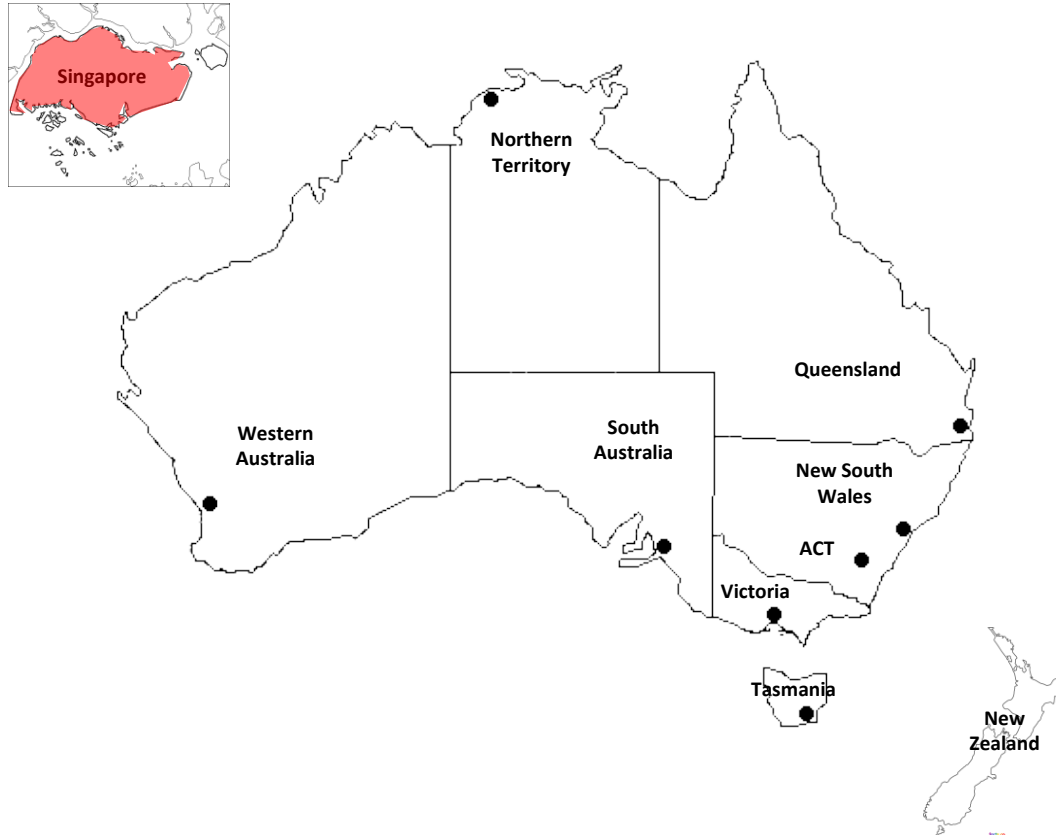

- From March 2018, SLA opened up the **Registered Surveyors (RS) Portal** for registered surveyors to trial their submissions in SG LandXML format. SLA has planned to officially launch the Portal in the 3rd quarter of 2018. At that time all surveyors are required to submit in this new format.
- Thus far, **three software vendors** have come on board. Two of them are local vendors and the third is LISTECH.
- SLA has conducted training for the surveyors to use the new system and to submit in SG LandXML format.
- The new submissions are still in 2D. Immediate next step will be moving to 3D.

ICSM ePlan Working Group Updates - ACT

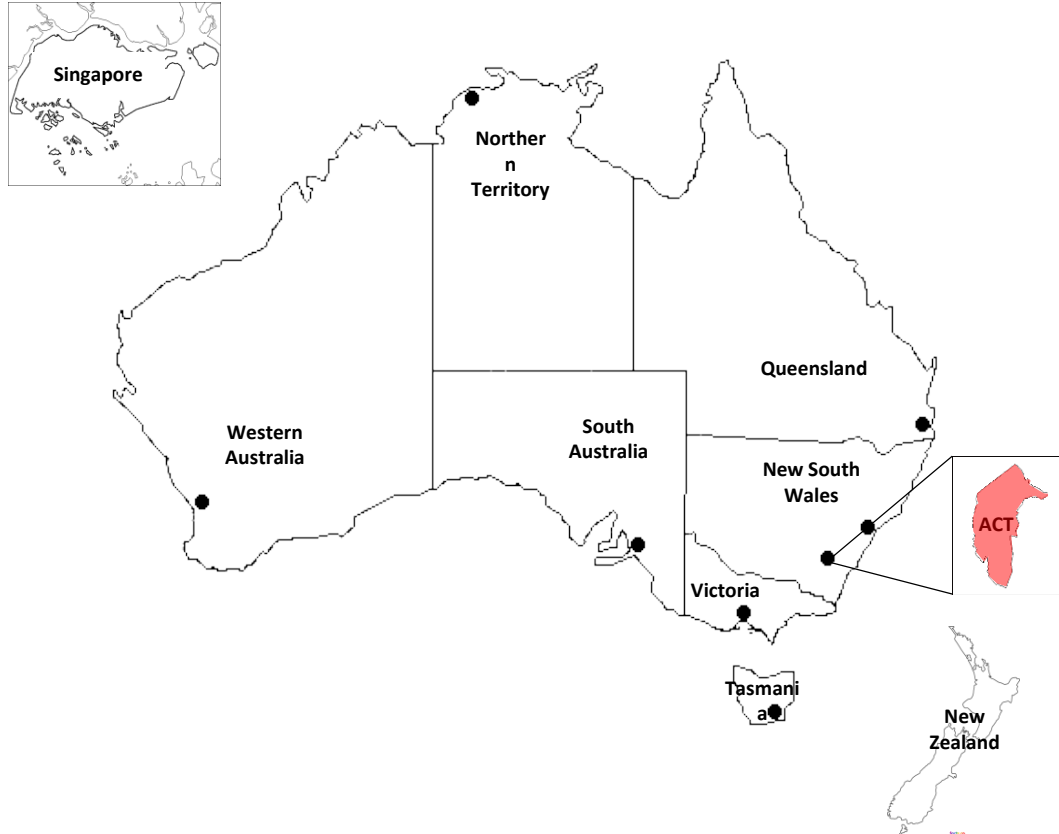

- A Project team is being formed to upgrade the **Territory's Spatial Data Management System**
- A component of the upgrade will be the **transfer and input of data into the DCDB**
- **Trials** have been carried out using the LandXML format to lodge digital data
- The **Scoping Study** carried out last year identified a process to create a parcel fabric from the existing survey accurate DCDB

ICSM ePlan Working Group Updates - SA

- An **Electronic Plan Lodgement** portal since 2008
- Through the examination process XML files are generated for capture in the DCDB



ICSM ePlan Working Group Updates - WA

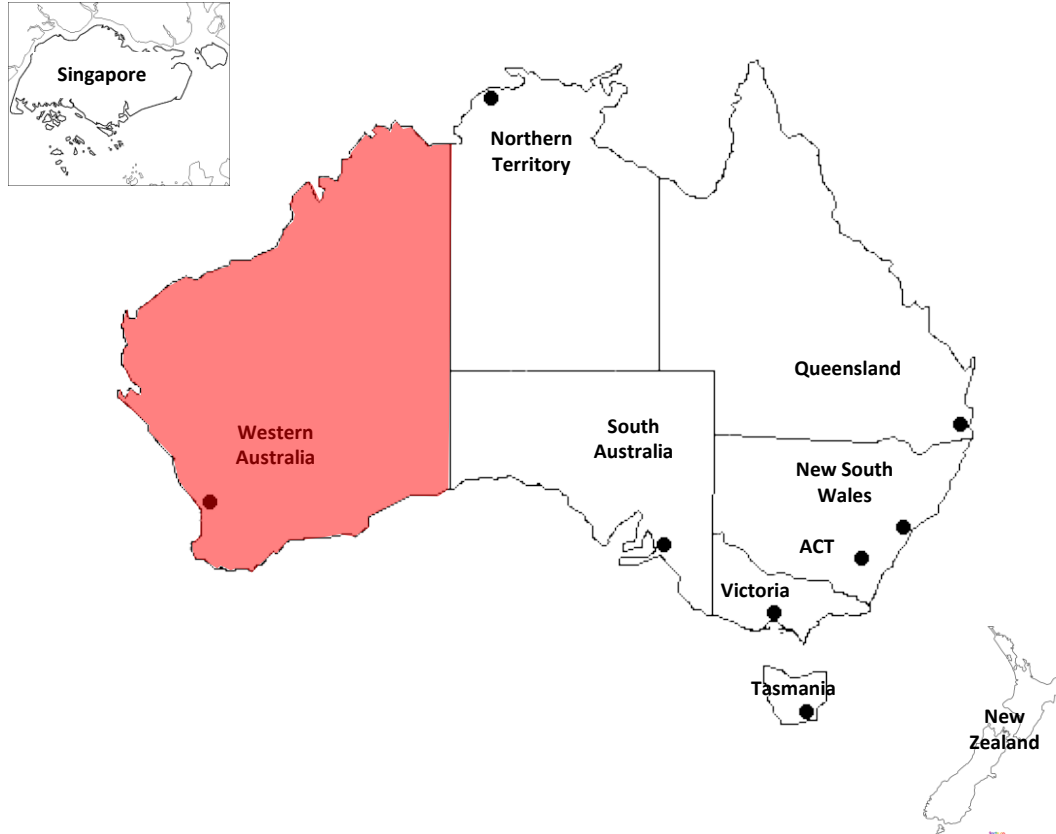

- The **New Land Registry – Plan (NLR-P)** Surveyors Portal is progressing well
- **Portal generated plans** – Creation of fully digital survey data to generate the plan image with one source of truth for all cadastral information to facilitate efficient lodgement, examination, planning approval and new title creation
- 42 portal plans lodged as at 6 March 2018

ICSM ePlan Working Group Updates - NT

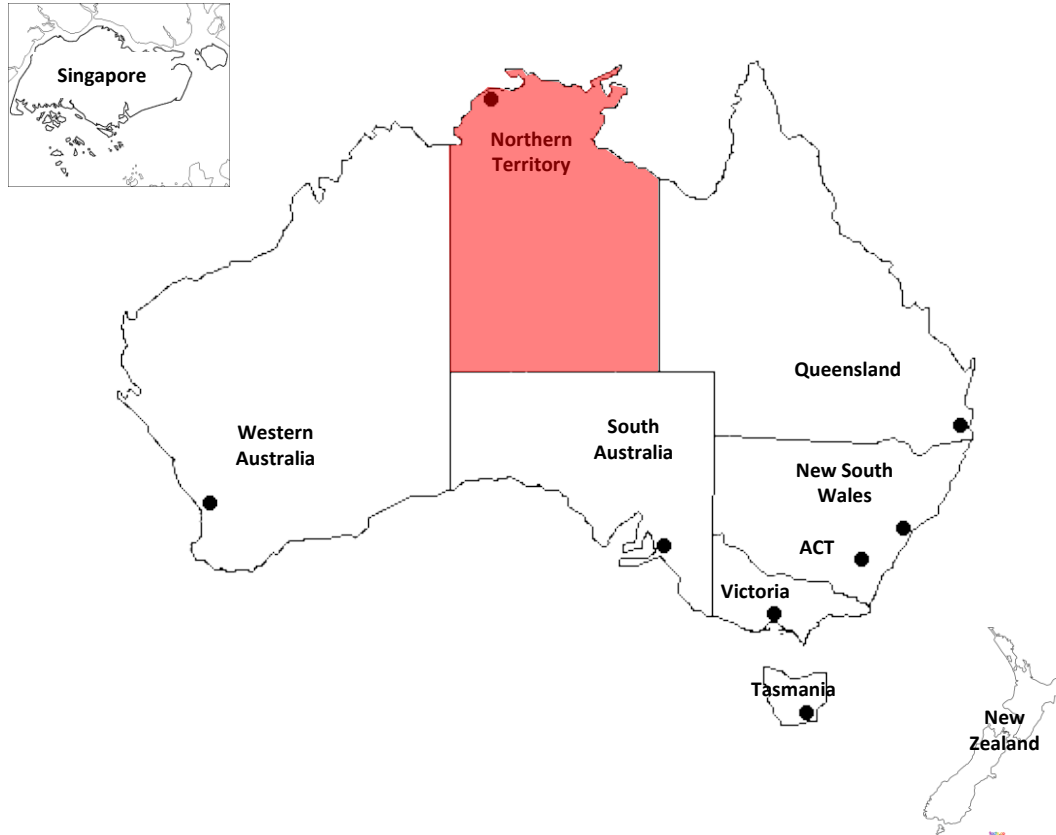

- A paper-based system prior to 2014
- In Jul 2014, Survey plan lodgement process moved to digital lodgement of the survey data with hardcopy plans
- Feb 2016, released **Survey Approvals Online (SAO)** Stage 1- development of a client portal for the allocation of survey data, creation of parcel numbers and survey reference numbers for the majority of survey job types
- In Jul 2016, SAO Stage 2 - The majority of survey job types to have the survey data lodged through the SAO gateway electronically for approval
- Geo-data software in **.acs** file format or **CEXML** continues to this day as digital data lodgement with PDF survey plans
- Looking to move to **3D model of Cadastre**

ICSM ePlan Working Group Updates - TAS



- The **Tasmanian Online Plan system (TOP)** will enable the creation of plan-related documents and the lodgement of digital images
- Clients will be able to use their in house systems for plan preparation with the ability to upload these digital plan images directly into TOP
- The TOP system has been developed with the functionality for **full electronic lodgment of plans** and with the capability for changes to reflect future legislative or policy changes
- A council, a surveying firm and a solicitors firm have entered into agreements to use TOP. A plan has yet to be prepared and presented using TOP, however it is expected that one will be at the first opportunity that arises.

Victorian ePlan Services Demo

ePlan Services Demo

Electronic Subdivisions Unit (ESU)
Land Registry Services
Land Use Victoria

Visualisation

Spatial
analysis

ePLAN

Validation

Digital
Examination

DCDB
Upgrade

LandXML

Victorian ePlan 2025 Roadmap

Short-term Vision:

- Provide the infrastructure and services to enable the submission and registration of ePlan for all 2D Victorian cadastral plans by 2020
 - Support field notes in ePlan
 - Support digital submission of subdivision land and plan metadata for building subdivision

Long-term Vision:

- Implement ePlan for all cadastral plans & surveys by 2025
 - Support 3D digital cadastre

Thank You!



Dr Hamed Olfat

ePlan Coordinator | Electronic Subdivisions Unit (ESU) | Land Use Victoria

Chairman of Technical Committee | ICSM ePlan Working Group

Hamed.Olfat@delwp.vic.gov.au, (03) 9194 0513

