

GEOSMART ASIA - LOCATE 18

Adelaide Convention Centre

9-11 April 2018

GEOSMART
ASIA 2018

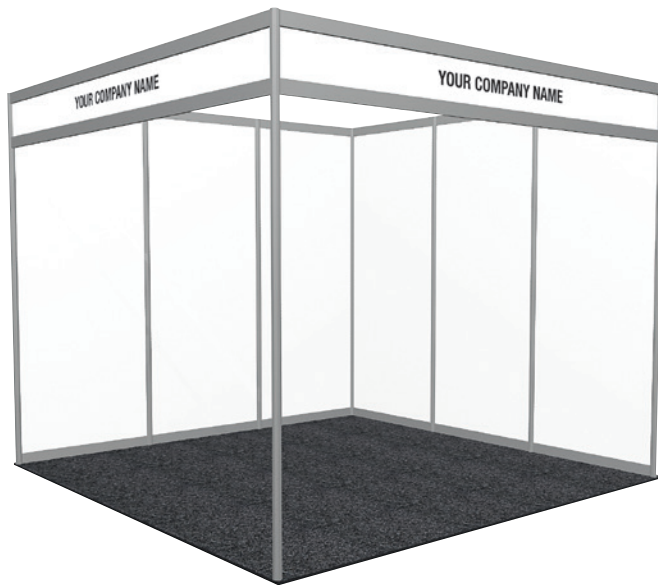

Included in your Octanorm booth package

3.0m x 3.0m booth with PVC walls and fascia.

Walls

White with a height of 2.5m.

Fascia Sign

White corflute sign with digitally printed lettering.

Row booths have 1 fascia sign, corner booths have 2 fascia signs. Custom signage options are available \$POA.

Lighting

2 x 120 watt LED spotlights installed behind the fascia.

Power

1 x 4 amp power point.

Carpet

Charcoal.

Custom flooring options are available below. \$POA

Booth Furniture

1x Table

2x Chairs

1x Dust Bin



Your Exhibition Coordinator is:

Kim Sluggett

P: +61 8 8350 2306

F: +61 8 8350 2301

E: kims@aehe.com.au

W: www.aeh.com.au

31 Deeds Road,

North Plympton, SA 5037

The Do's and Don'ts of your booth

To protect the walling we ask that you **DO NOT** use stickers, adhesive, sticky tape, double sided tape, glue, nails, staples, screws or pins.

To attach promotional material to our walling we ask that you use velcro (both hook & loop for white smooth finish walls / hook only for black carpeted walling), wall shelves (weight limits apply), slat walls or hook and chain

(All of these items are available from AEH). If panels require repairing, replacing or cleaning the cost will be charged to the Exhibitor.

*Prices not inclusive of gst, damage waiver, delivery or collection and are for the duration of the exhibition, not exceeding 10 days. All prices are in Australian Dollars.

Items are subject to availability. Adelaide Expo Hire reserves the right to change prices or our terms and conditions at any time.

Flooring Options

Carpet tiles



Charcoal



Blue



Red

Carpet Floor \$POA

1m x 1m square carpet tiles

■ Code: 678 ■ Code: 620

■ Code: 653

Please note that colours shown may not match the exact colour or style and are indicative only.

Raised floors



Ash



Oak



Teak

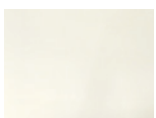

White



Atlanta Cherry



Decking

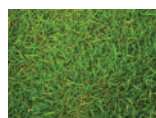

Grass

Raised Floor \$POA

Colours: White, Teak, Atlanta Cherry, New Age Oak, Painted Ash.

Custom digital prints are available in your own design \$POA.

Code: Floor Kit Colour

Please note that colours shown may not match the exact colour or style and are indicative only.

Custom Digital
Print Available!



FASCIA ORDER FORM

Event: GeoSmart Asia - Locate 18		Event Date: 9-11 April 2018
Venue: Adelaide Convention Centre		Stand Number:
Company Name:	ABN:	
Address:		
Suburb:	State:	Postcode:
Contact Name:		
Email:		
Phone:	Fax:	Mobile:

Please select one of the options below for your fascia sign

- ☐ **A. Standard Fascia** text as included in your booth package. Please specify your text in the box below.
- ☐ **B. Logo Fascia** (\$100.00+gst) Upgrade your fascia to include your logo. Please supply a high resolution pdf or illustrator file of your logo. A proof will be emailed to you for approval. Changes to this initial artwork may incur additional fees.
- ☐ **C. Logo Fascia** (\$100.00+gst) Upgrade your fascia to include your logo. Please supply a high resolution pdf or illustrator file of your logo. A proof will be emailed to you for approval. Changes to this initial artwork may incur additional fees.

A	01	YOUR COMPANY NAME	
B	01		YOUR COMPANY NAME
C	01		

Please specify the text to be printed on your fascia sign. Maximum of 30 characters.

--

Please select if you DO NOT require the front structure on your booth

- ☐ **No Front Structure Required**

Your fascia sign will be attached to the rear wall of your booth. Should you choose to remove the front structure from your booth we may be required to install walling returns to provide structural support for your walls. Changes to booth configuration on site including the removal of fascia boards will incur a fee of \$100.00+gst.

Important Note: This form must be completed and returned by the due date. Late orders will show your company name as provided to us by the event organiser. Any changes required after production of this fascia sign incur a fee of \$100.00+gst per fascia.

Your Exhibition Coordinator is:

Kim Sluggett

P: +61 8 8350 2306

F: +61 8 8350 2301

E: kims@aehe.com.au

W: www.aeh.com.au

31 Deeds Road,
North Plympton, SA 5037



AEH Exhibitions

*Prices not inclusive of gst, damage waiver, delivery or collection and are for the duration of the exhibition, not exceeding 10 days. All prices are in Australian Dollars.

Items are subject to availability. Adelaide Expo Hire reserves the right to change prices or our terms and conditions at any time.

UPGRADE PACKAGES



Promote

3m x 3m corner

\$3,700.00

6m x 3m peninsula

\$5,275.00

Inclusions

- Raised floor – white
- 10 amp power and 4 way power board
- Lighting as shown
- Lockable storage



Diana

3m x 3m corner

\$7,232.00

6m x 3m peninsula

\$7,880.00

- Signage as shown
- Installation and dismantle, damage waiver, delivery and collection of stand
- Colour options possible



Olinto

3m x 3m corner

\$8,745.00

6m x 3m peninsula

\$10,300.00

Additional items

- Audio visual
- Furniture and plants
- Damage waiver, delivery and collection applies to additional items only

Apply wall graphics to any booth for maximum visual impact.



Printed Wall Graphics

3m x 3m corner

\$1,770.00

6m x 3m corner

\$2,655.00

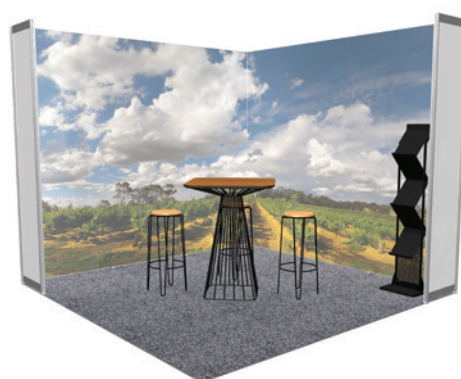

Fabric Wall Graphics

3m x 3m corner

\$2,540.00

6m x 3m corner

\$3,810.00

Price includes printed graphics & installation only. Does not include walling, furniture and flooring. All prices are in Australian Dollars.

*Prices exclude GST, and are for the duration of the exhibition, not exceeding 10 days. Items are subject to availability. All signage files are to be provided according to our Artwork Guidelines as print ready PDF documents. Adelaide Expo Hire reserves the right to change prices or our terms and conditions at any time. www.aeh.com.au

FURNITURE PACKAGES



Houghton Bar Package

\$355 (normally \$445)

- 1 x Houghton bar table ☐ ☐ ☐ ☐
- 3 x Brompton stools ☐ ☐ ☐ ☐
- 1 x Adelaide brochure stand ☐ ☐

Code: 0578P



Beaumont Counter Package

\$410 (normally \$510)

- 1 x Beaumont counter ☐ ☐
- 2 x Highgate stools ☐ ☐
- 1 x Wayville pop up brochure stand

Code: 0838P

Enhance option – counter signage (\$125)



Moana Tub Package

\$505 (normally \$630)

- 3 x Moana tub chairs
- 1 x Skye coffee table ☐ ☐

Code: 0148P

Enhance option – 3 x cushion pack (\$48)



Alberton Ottoman Package

\$340 (normally \$425)

- 1 x Alberton bench seat ☐ ☐ ☐ ☐
- 2 x Alberton cubes ☐ ☐ ☐ ☐
- 1 x Kingscote rectangular coffee table ☐ ☐

Code: 0175P



Houghton Café Package

\$300 (normally \$375)

- 1 x Houghton café table ☐ ☐ ☐ ☐
- 3 x Brompton chairs ☐ ☐ ☐ ☐
- 1 x Adelaide brochure stand ☐ ☐

Code: 0538P



Tusmore Café Package

\$365 (normally \$455)

- 1 x Tusmore cafe table ☐ ☐ ☐
- 2 x Lonsdale chairs ☐ ☐
- 1 x Enfield cupboard ☐ ☐

Code: 2845PU



Kensington Lounge Package

\$725 (normally \$905)

- 1 x Kensington 2.5-seater lounge ☐ ☐ ☐
- 2 x Tennyson lounge chairs ☐ ☐ ☐
- 1 x Ethelton coffee table
- 1 x Kadina magazine rack

Code: 0161P

Enhance option – 4 x cushion pack (\$64)



Tusmore Bar Package

\$430 (normally \$540)

- 1 x Tusmore bar table ☐ ☐ ☐
- 3 x Penfield bar stools
- 1 x Stirling cupboard ☐ ☐

Code: 2844PO



Blackwood Bar Package

\$560 (normally \$700)

- 1 x Blackwood bar table
- 4 x Somerton Park stools ☐ ☐ ☐ ☐
- 2 x Vista artificial desktop plants
- 1 x Unley ladder unit

Code: 2846P



Brighton Lounge Package

\$720 (normally \$900)

- 2 x Brighton 2-seater lounges
- 1 x Ethelton coffee table
- 1 x Unley ladder unit
- 1 x Richmond lamp

Code: 0159P

Enhance option – 4 x cushion pack (\$64)

EXTRAS



Standard



Classic

Pull Up Banner

Fast and easy to erect, solid construction, padded carry bag, lightweight and portable.

Standard 850

\$180 +GST RRP
850(w) x 2150mm(h)

Visual area

850(w) x 2000mm(h)
The bottom 150mm
is hidden inside the unit.

Classic 850

\$240 +GST RRP
850(w) x 2150mm(h)

Visual area

850(w) x 2000mm(h)
The bottom 150mm
is hidden inside the unit.

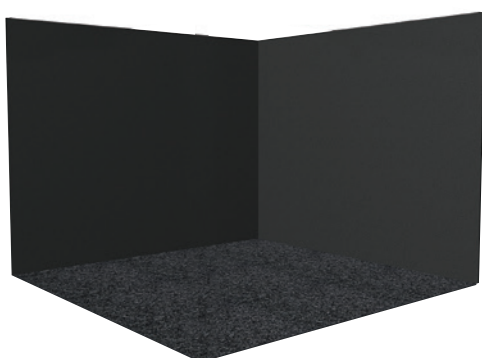

Walling

\$30+gst per lineal metre

2.4m high exhibition walling with velcro compatible fabric.
Optional colours of black, blue or white.

Please specify quantity required on order form attached.



Wingfield Slat Wall

Octanorm \$200 Corinthian \$160

Corinthian 1000(w) x 2400mm(h)

Code: 5013

Octanorm 950(w) x 2340mm(h)

Code: 5009

(No hooks provided).

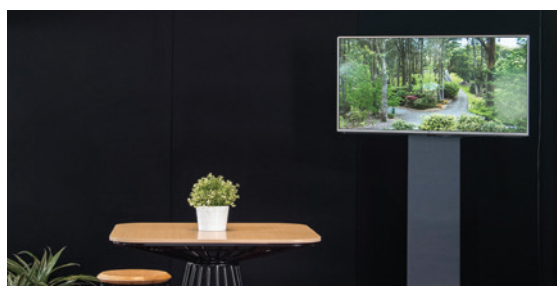

Audio Visual

A variety of audio visual equipment is available for hire to suit your needs.

- LCD Screens (with audio)
- Seamless LED Screens
- Laptops
- iPads
- Audio Equipment
- PA systems



Plants and Fresh Flowers

Plants and fresh flowers are available for hire for your event. Plants may appear slightly different than pictured due to the living nature of the product.

ORDER FORM

Event: GeoSmart Asia - Locate 18		Event Date: 9-11 April 2018	
Venue: Adelaide Convention Centre		Stand Number:	
Company Name:		ABN:	
Address:			
Suburb:		State:	Postcode:
Contact Name:			
Email:			
Phone:	Fax:		Mobile:

For our complete range of hire items and our terms and conditions please refer to our website www.aeh.com.au

[illegible]

Credit Card Payments: Visa & Mastercard attract a processing fee of 1.3%+gst. Amex attracts a processing fee of 3.0%+gst.

Please select card ☒

☐ Visa ☐ MasterCard
☐ Amex

Card
No.:

--	--

CVV
No.:

Expiry
Date:

Expiry
Date:

Name on card:
(Please Print)

Signature: _____

Your Exhibition Coordinator is:

Kim Sluggett

P: +61 8 8350 2306

F: +61 8 8350 2301

E: kims@aeh.com.au

W: www.aeh.com.au

31 Deeds Road,
North Plympton, SA 5037



AEH Exhibitions

*Prices not inclusive of gst, damage waiver, delivery or collection and are for the duration of the exhibition, not exceeding 10 days. All prices are in Australian Dollars. Items are subject to availability. Adelaide Expo Hire reserves the right to change prices or our terms and conditions at any time.